

**NOTE:**

1. CURB STOP LOCATION IS APPROX. 0.30m FROM FRONT PROPERTY LINE INTO THE ROAD ROW.
2. ALL FOUNDATION CONCRETE IS TO BE TYPE 50 (SULPHATE RESISTANT) CEMENT WITH A 56-DAY COMPRESSIVE STRENGTH OF 32 MPa AND WITH A MAXIMUM WATER TO CEMENTING MATERIAL RATIO OF 0.45. THE ADDITION OF +5.% AIR ENTRAINMENT IS ALSO RECOMMENDED FOR CONCRETE EXPOSED TO FREEZE-THAW CONDITIONS.

**-DRAFT COPY-**

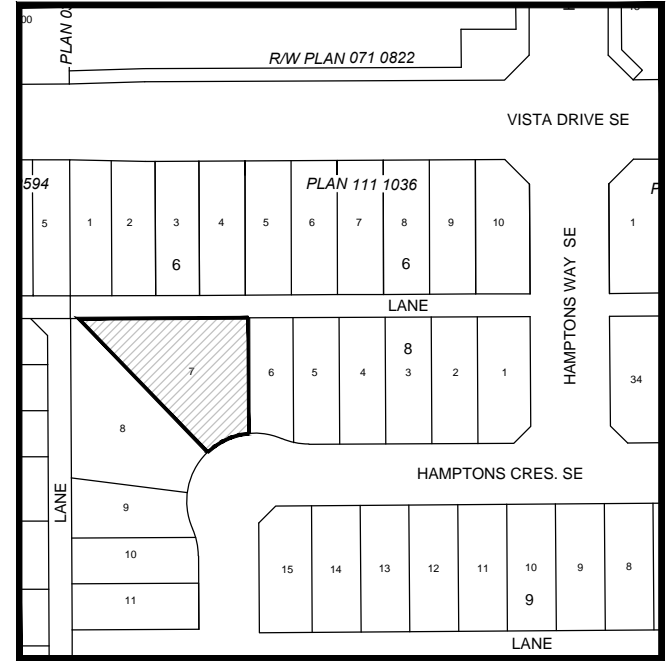
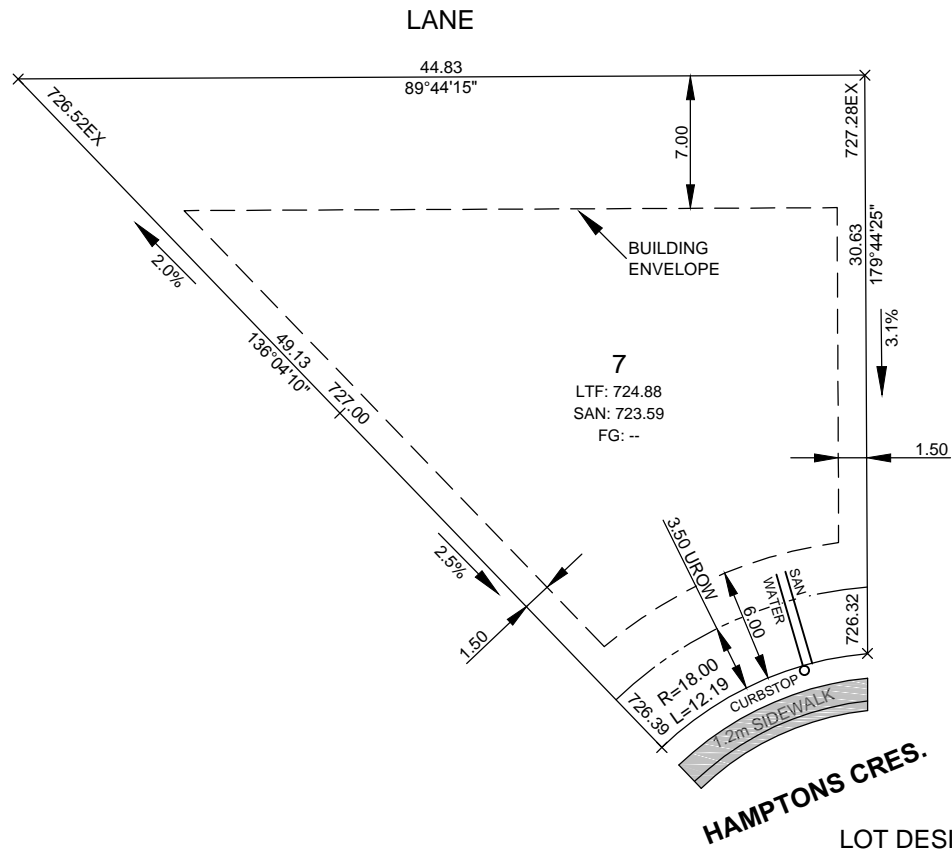

**LOT LOCATION**  
SCALE 1:2000

**NOTE:**

- SHALLOW UTILITY INFRASTRUCTURE NOT SHOWN.

LOT GRADES ON THIS  
PLAN ARE DESIGN GRADES

**LEGEND:**

- LTF = LOWEST TOP OF FOOTING
- SAN = SANITARY INVERT SHOWN AT PROPERTY LINE
- FG = RECOMMENDED FINISHED GRADE ALONG FRONT OF HOUSE

**LOT DESIGNATION:**  
TYPE B/D -  
3-6% OVERALL LOT SLOPE  
REAR TO FRONT DRAINAGE/  
STANDARD SPLIT DRAINAGE

**R-1**  
**SITE PLAN**  
SCALE 1:400

LANSDOWNE EQUITY VENTURES LTD.  
PHASE 2B - MEDICINE HAT, AB

LOT 7, BLOCK 8, PLAN --- ---  
88 HAMPTONS CRESCENT S.E.

FOOTING CHECK:

Actual Top of Footing

Date

Surveyor



106 Westside Common  
2201 Box Springs Blvd. NW  
Medicine Hat, AB T1C 0C8  
403-581-0009  
www.finleyhann.com