



BRAVADA HOMES

Quality, Elegance, Comfort

605 VISTA DRIVE

COMPLETION: WINTER 2015

\$439,900 INC. LOT & GST

- type - **bi-level**
- bedrooms - **3**
- bathrooms - **2**
- garage - **2 car**
- total area - **1562 sq. ft.**

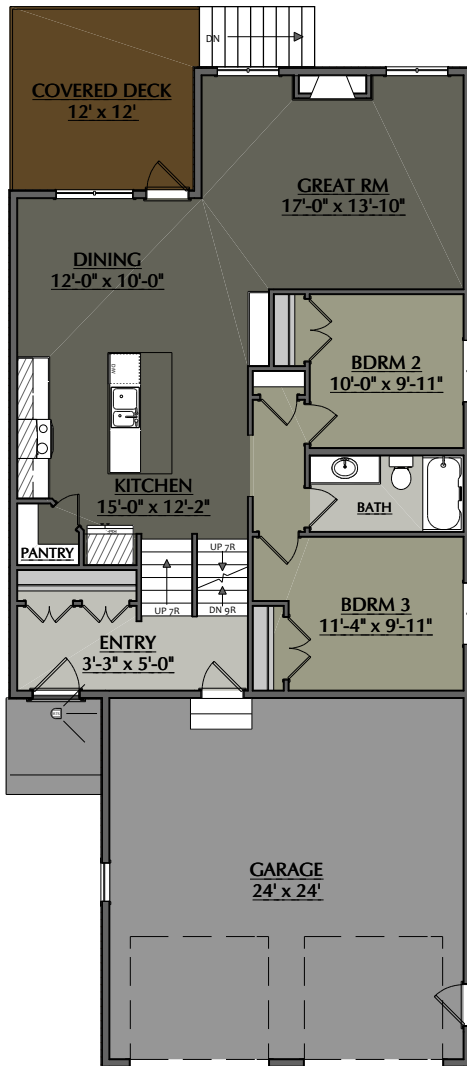

MAIN FLOOR

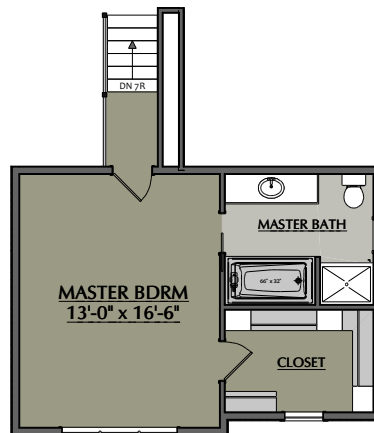

2ND FLOOR

- DECKING
- LAMINATE / HARDWOOD
- CARPET
- VINYL / TILE
- CONCRETE

FEATURES

- vaulted main floor
- vaulted master bdrm
- gas fireplace
- large kitchen
- stainless steel appliances
- quartz countertops
- walk-in pantry
- 4 piece ensuite
- finished/heated garage
- driveway included

403.548.5837

www.bravadahomes.com